



## CELLFLEX® Factory-Fit Jumper Assembly, 1/2" Superflexible Foam, 7-16 DIN Male / 7-16 DIN Female, 2.0 m

Radio Frequency Systems' CELLFLEX® Factory-Fit Jumpers feature specially designed connectors which are soldered-on in a strictly controlled industrial process to ensure industry leading performance for today's high-performance wireless systems. The connector design and manufacturing process has been optimized to produce premium VSWR and IM levels. Injection molded boots provide reliable and repeatable additional sealing level and strain relief. Our facilities produce and stock all popular lengths as required by the industry, and can deliver custom lengths with premium VSWR and IM levels on request.



Picture shows 7M7FS12-0100FFP for illustration purpose

### FEATURES / BENEFITS

- ➔ **Stable premium VSWR, outstanding and consistent intermodulation performance**  
Improved network performance, reduces the number of dropped calls and avoids revenue loss
- ➔ **Waterproof to IP 68**  
No downtime risk, secures revenue.
- ➔ **Jumper label is serialized**  
Ensure traceability.
- ➔ Available with standard "J" or flame retardant "JFN" jacket types  
Usable in all applications.
- ➔ **Compliant to RoHS (EU) and CRoHS (China)**  
Usable on a global basis.

### Technical Features

#### STRUCTURE

Cable Type		1/2" Superflexible Foam
Jumper Type		Factory-Fit (Premium)
Connector A		7-16 DIN Male
Center Contact Connector A		Brass, Silver plated
Outer Contact Connector A		Brass, Trimetal plated
Coupling Nut Connector A		Hexagon nut, Nickel plated
Connector B		7-16 DIN Female
Center Contact Connector B		Spring bronze, Silver plated
Outer Contact Connector B		Brass, Trimetal plated
Dielectric		PTFE
Gasket		Silicone rubber
Jacket		Black Polyethylene

#### MECHANICAL SPECIFICATIONS

Length	m (ft)	2 (6.6)
Minimum Bend Radius	mm (in)	32 (1.25)

#### TESTING AND ENVIRONMENTAL

Sealing class		IP68
---------------	--	------

#### ELECTRICAL SPECIFICATIONS

Intermodulation	dBc	≤ -159 (- 161 typical)
VSWR, Return Loss	VSWR (dB)	≤ 1.052 (32) @ 10 - 1000 MHz ≤ 1.065 (30) @ 1000 - 1700 MHz ≤ 1.065 (30) @ 1700 - 2200 MHz ≤ 1.083 (28) @ 2200 - 2700 MHz

#### TEMPERATURE SPECIFICATIONS

Installation Temperature	°C (°F)	-40 to 60 (-40 to 140 )
Operation Temperature	°C (°F)	-50 to 85 (-58 to 185 )
Storage Temperature	°C (°F)	-70 to 85 (-94 to 185 )



**CELLFLEX® Factory-Fit Jumper Assembly, 1/2" Superflexible Foam, 7-16 DIN Male / 7-16 DIN Female, 2.0 m**

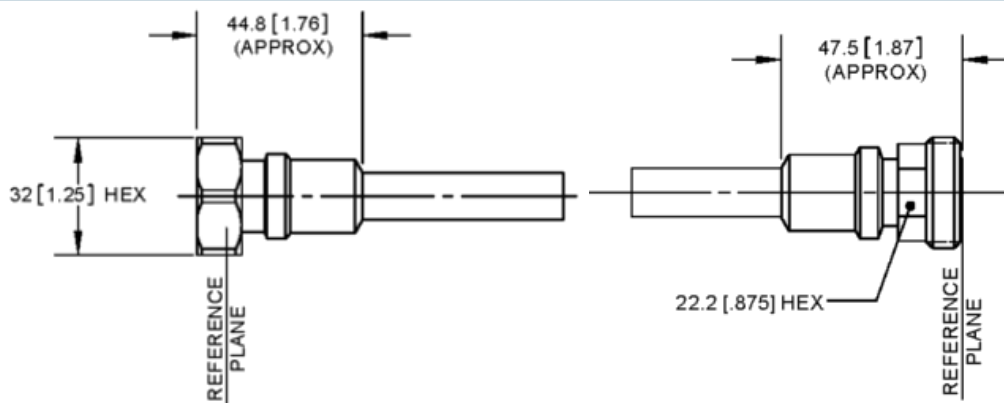

**External Document Links**

Cable SCF12-50J  
Handling instruction

**Notes**